

Managing inspection settings

- Select **Inspection Settings** on the **Main Menu**.

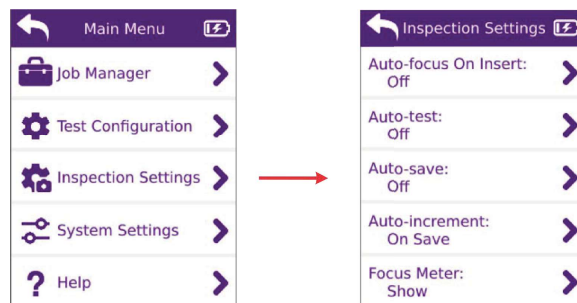

Table 3-3: Inspection settings

Settings	Description
Auto-focus On Insert	Automatically focus Live view when a fiber is mounted onto the fiber inspection tip. <ul style="list-style-type: none"> Off On (Default)
Auto-test	Automatically start a test when autofocus is performed. <ul style="list-style-type: none"> Off On Autofocus (Default)
Auto-save	Automatically save data when a Pass/Fail test is completed. <ul style="list-style-type: none"> Off (Default) If Pass If Fail Always
Auto-increment	Automatically increment the test label (ID) to the next available number on save. <ul style="list-style-type: none"> Off On Save (Default) On Save If Pass <p>Note: The Test ID label that appears on the Home screen shows the test ID to which test results will be assigned when saved either automatically or manually. To avoid overwriting test results already assigned to a test ID in the current job, enable the On Save option.</p>
Focus Meter	Focus meter visibility. <ul style="list-style-type: none"> Hide (Default) Show
Saved Image	Saved image quality: <ul style="list-style-type: none"> Standard Fidelity (Default) Compatibility Mode
MPO Pan Range	<ul style="list-style-type: none"> Standard (Default) Wide

Managing system settings

- Select **System Settings** on the **Main Menu**.

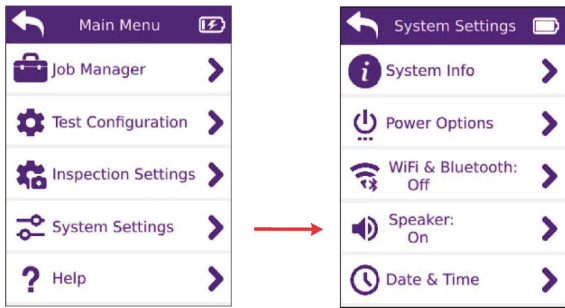

Table 3-4: System settings

Settings	Description
System Info	Software Version: Software version installed on microscope
	Serial Number: Microscope serial number
	Battery Info: <ul style="list-style-type: none">• Status: Charging or Discharging• Level: Battery charge percent• Voltage: Voltage output
	Network Info <ul style="list-style-type: none">• IP Address• WiFi Network Name• Bluetooth Address• MAC Address Note: Applies only to INX 700 Series Probe Microscopes with wireless connectivity.
	Regulatory Info: Regulatory compliance information. Tap to scroll through the available information.
	Open Source Licenses: List of OSS licenses
Power Options	Set power options for Auto Off, Auto Sleep, and Auto Screen Dim settings: <ul style="list-style-type: none">• No• 1 min• 5 min (Default)• 10 min• 30 min
WiFi & Bluetooth Note: Applies only to INX 700 Series Probe Microscopes with wireless connectivity,	Wireless connectivity status: <ul style="list-style-type: none">• Off (Default)• On
Speaker	Speaker status: <ul style="list-style-type: none">• Off• On (Default; sound emitted when Pass/Fail test passes or fails.)

Table 3-4: System settings (continued)

Settings	Description
Date & Time	System time and date settings: <ul style="list-style-type: none"> • System Time • Date Format • Time Format
Language	System language options: <ul style="list-style-type: none"> • English • Portuguese • Spanish • French • German • Simplified Chinese • Japanese
Options	Status of available options for the microscope: <ul style="list-style-type: none"> • Multifiber: Enabled/Disabled • Bluetooth & WiFi: Upgradeable Note: Applies only to INX 700 Series Probe Microscopes with wireless connectivity. • SmartAccess Anywhere: Enabled/Disabled • Simplex: Enabled/Disabled
Factory Reset	Perform a factory reset, which deletes all user data and settings available on the microscope. <p>Important: Ensure that all required data saved to the microscope is uploaded to the VIAVI Mobile Tech App before performing a factory reset. For information, refer to <i>Using the VIAVI Mobile Tech App with INX Series Probe Microscopes</i>, 22185265 (see “About this guide” on page v).</p>