

Viavi

ONX Mobile Tech

Tim Miller

VI.AVI
VI.AVI Solutions

MOBILE TECH APP

- Allows Users to Sync instruments to STRATASYNC. MOBILE TECH APP also provides the following functionality:
 - View and manager files on the instrument
 - View and manage local files, including craftsmanship photos
 - Remote Display and Operation
 - IN-APP Support Documentation
 - LINK to VIAVI Technical Support
-
- Note – MOBILE TECH APP is interoperable with TB2000, TB4000, TB5800, One EXPERT CATV and a host of other VIAVI Solutions instruments

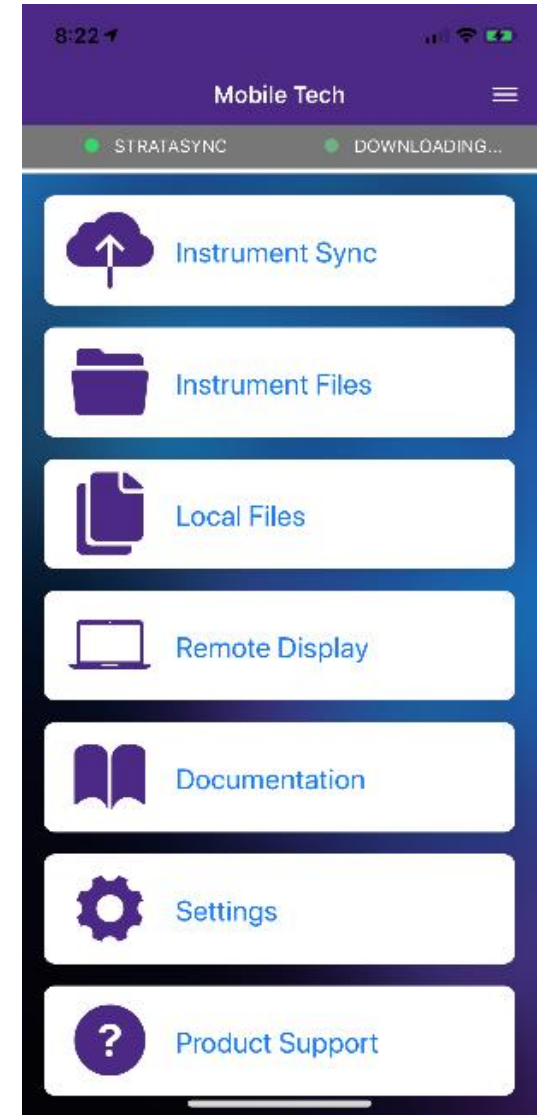

MOBILE TECH APP

Search for VIAVI and download VIAVI MOBILE TECH v3.1 app

* Screenshots shown on iPhone, but MOBILE TECH APP on ANDROID is consistent

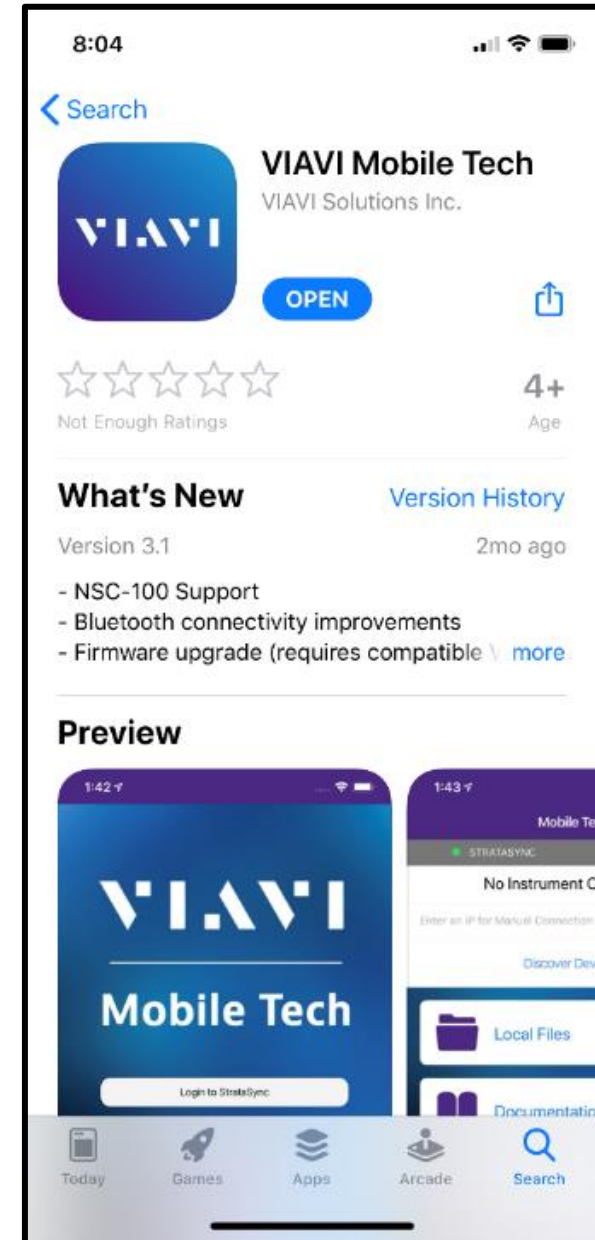

MOBILE TECH APP – Set Up

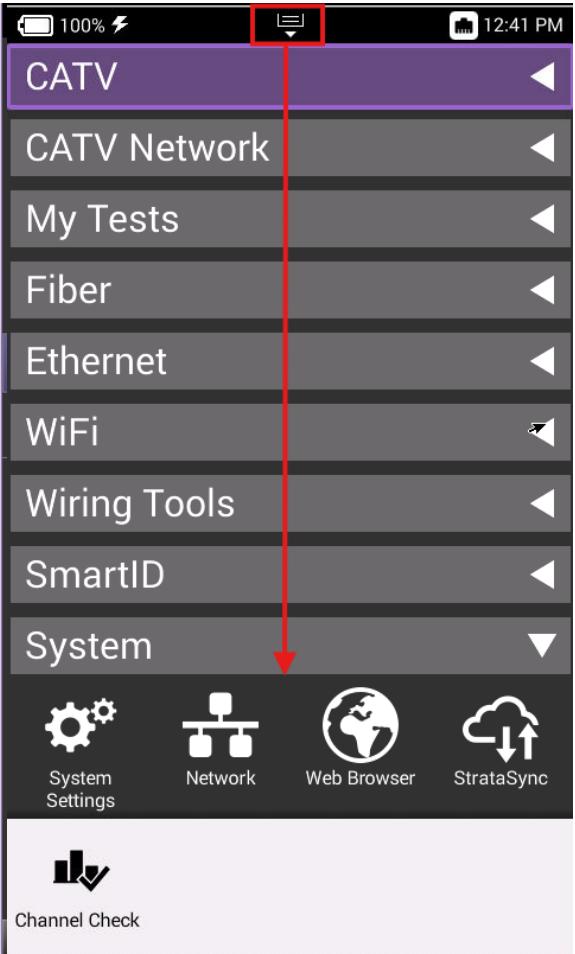

On ONX620 or 630, enable BLUETOOTH by going to SYSTEM SETTINGS->BLUETOOTH SETTINGS or by dragging down the TRAY and selecting BLUETOOTH and making sure it illuminates in GREEN

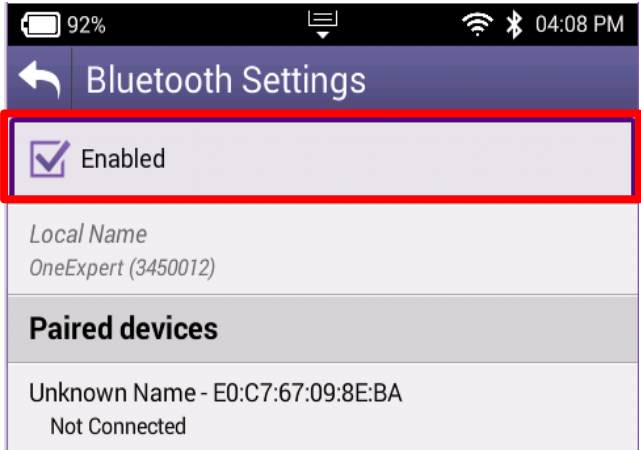
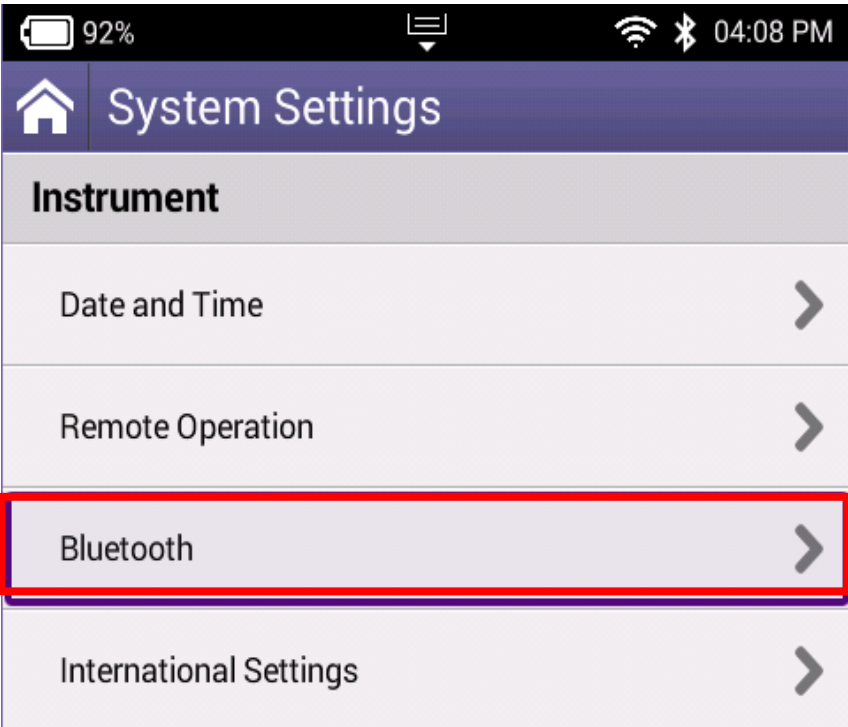

MOBILE TECH APP – Set Up

Select the appropriate OneExpert CATV serial number from the list of BLUETOOTH CONNECTIONS and pair

OneExpert CATV will flash a pairing request message, select YES

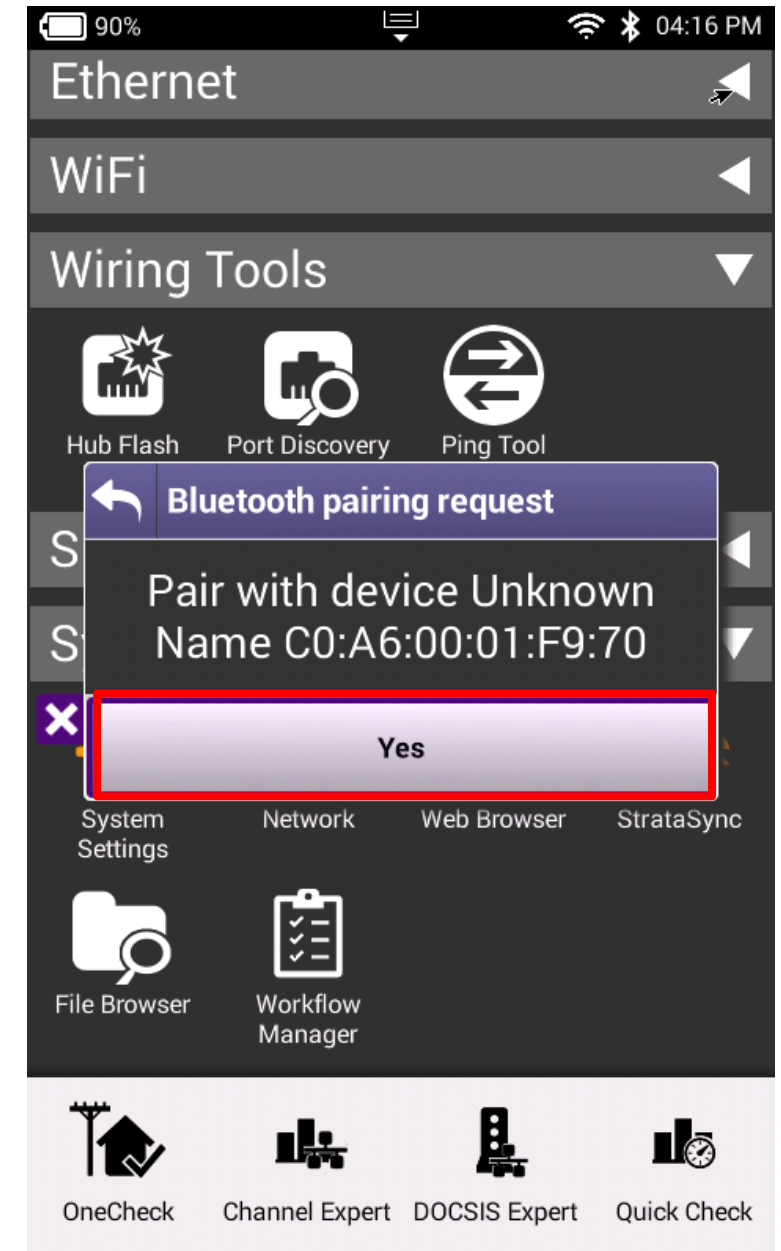
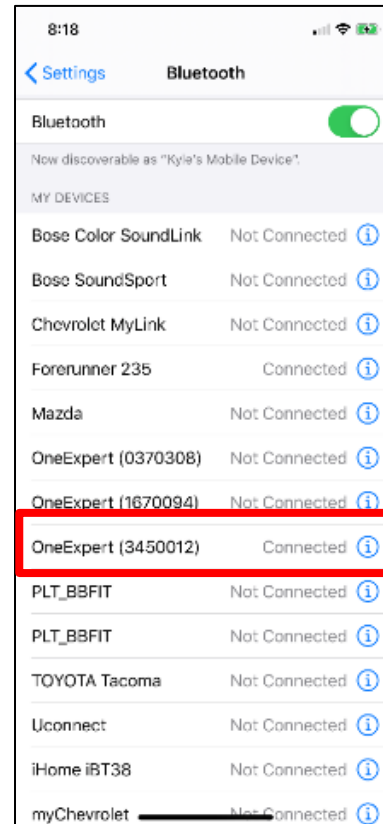
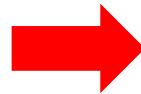
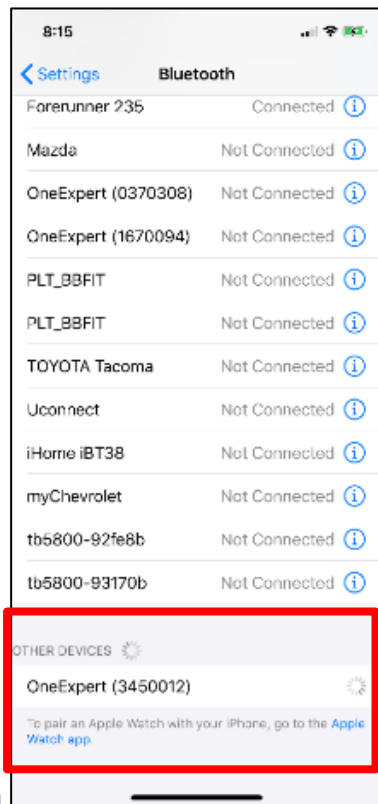

MOBILE TECH APP – Set Up

Login using USERNAME and PASSWORD
If user doesn't have login credentials – please reach out to local STRATASYNC ADMINISTRATOR

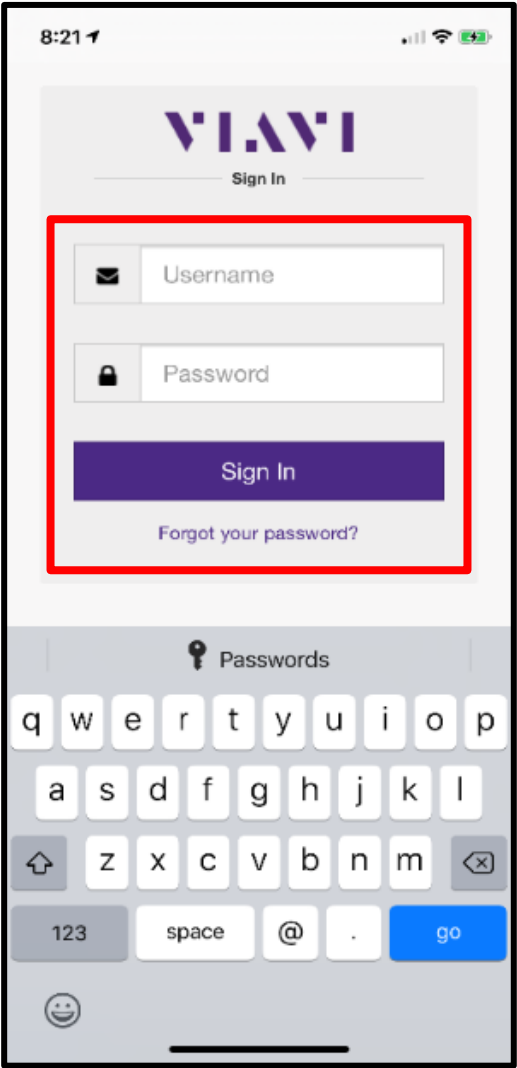
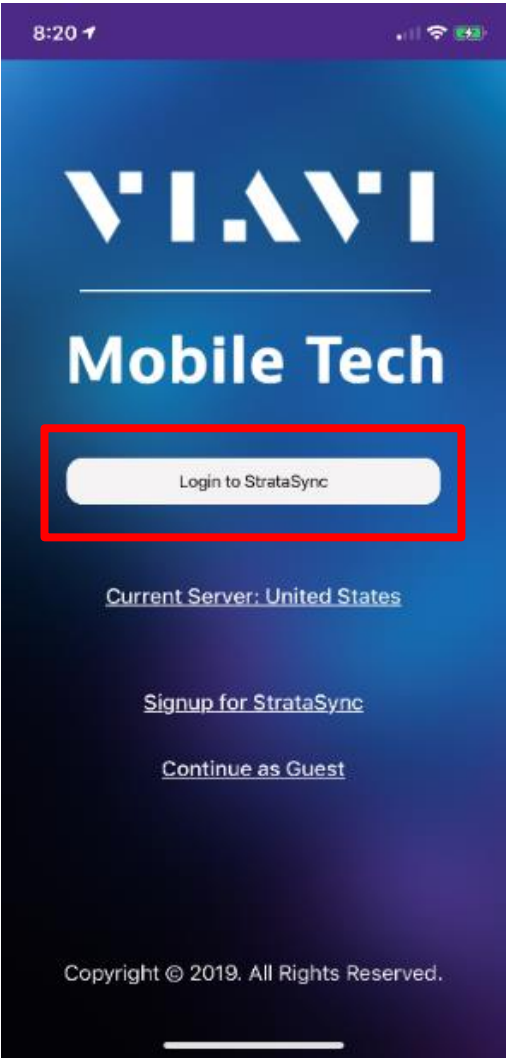

MOBILE TECH APP - Synchronization

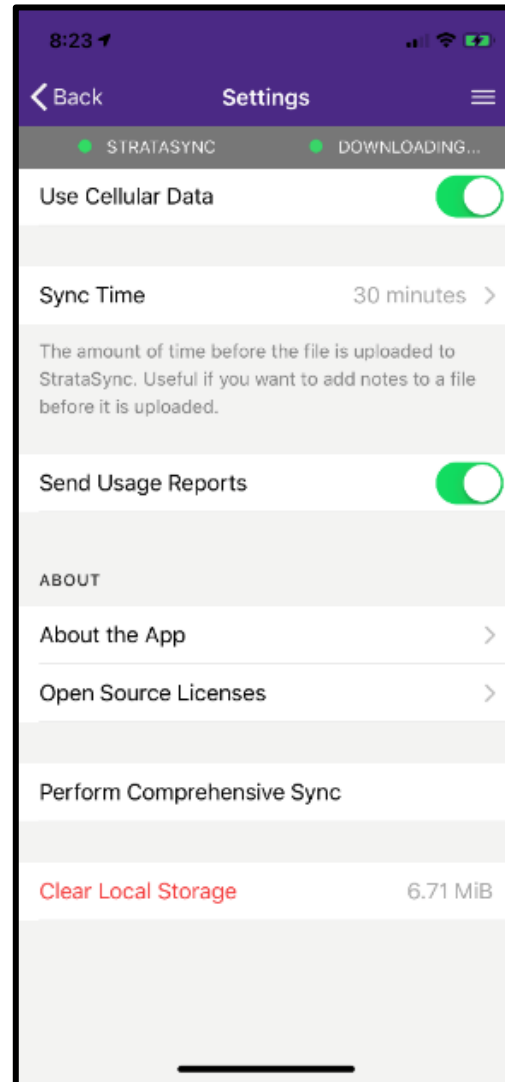
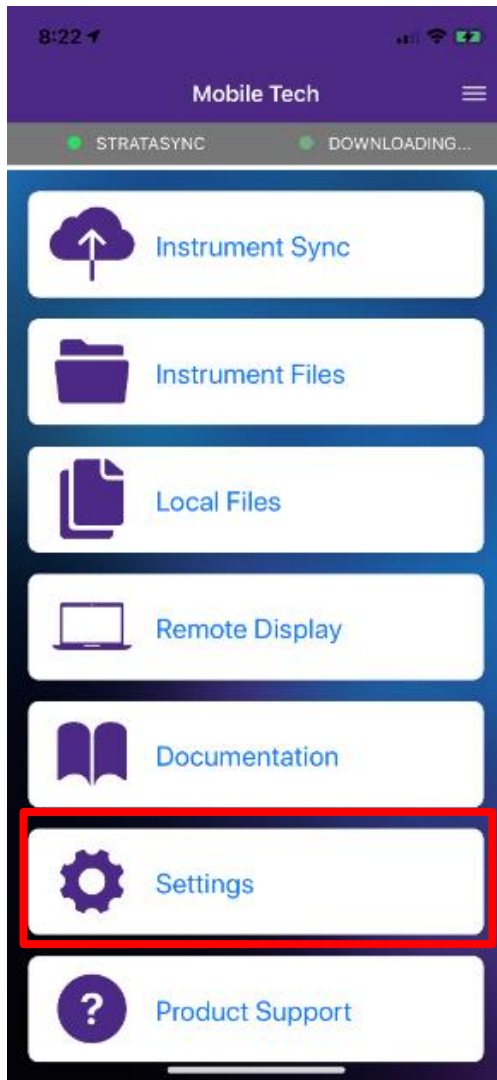

Select the SETTINGS button and configure MOBILE TECH APP

- Choose how often user desires a SYNC
- Whether the SYNC will require WIFI or may use the LTE connection
- Whether or not to send usage reports
- Comprehensive SYNC (useful for uploading failure logs)
- Clear local Storage on user phone

MOBILE TECH APP - Synchronization

By Selecting INSTRUMENT SYNC from the main menu, the USER can see all test data that has currently been saved to the ONX and is ready for sync

- **Note that only SAVED TEST DATA will migrate to MOBILE TECH APP for synchronization to STRATASYNC**

By selecting SYNC – the process will begin immediately

- The user can also rely on the timed sync setting – which allows the MOBILE TECH APP the ability to sync passively in the background at regular intervals

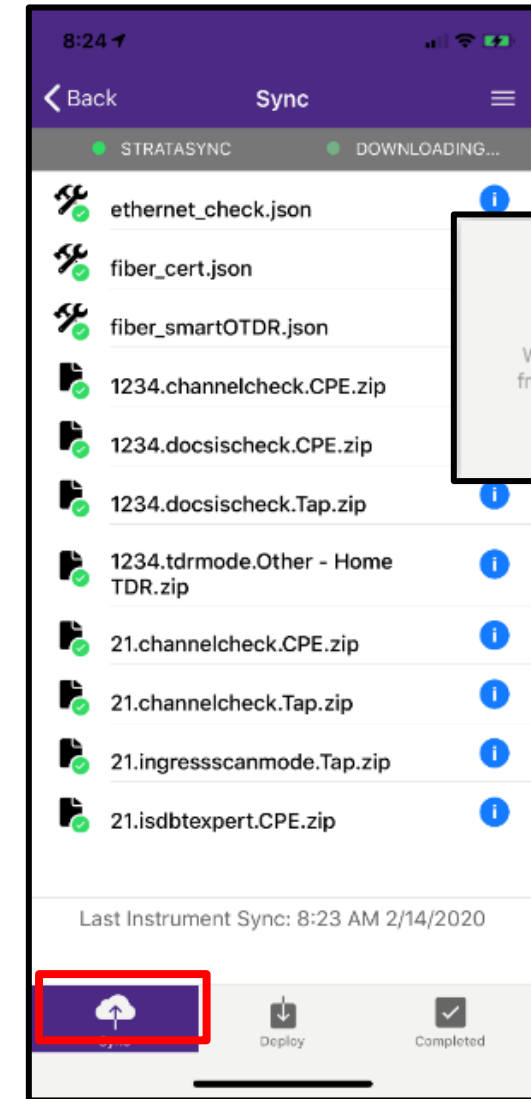
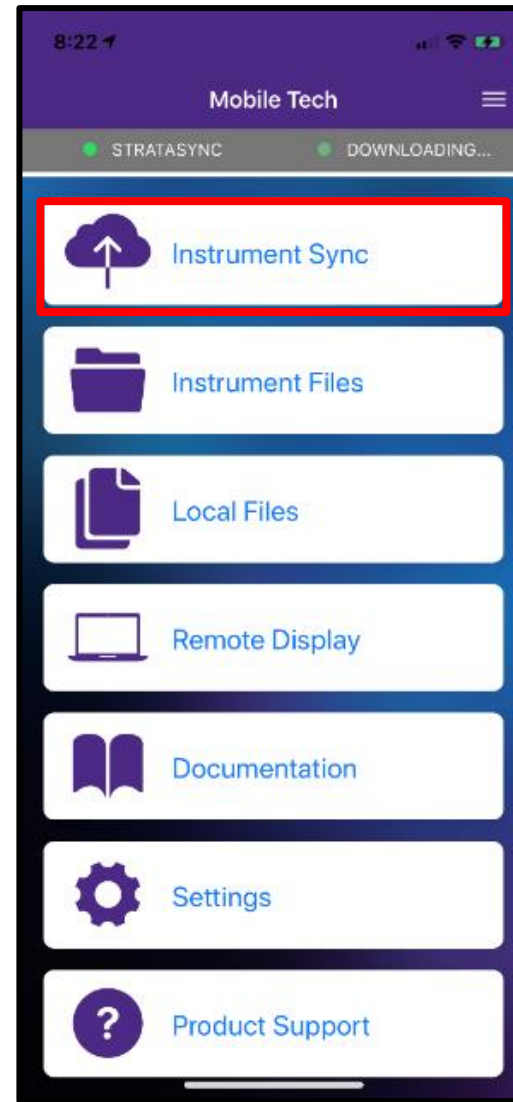

MOBILE TECH APP - Remote Display

REMOTE DISPLAY allows the user to control the ONX, via BLUETOOTH, and conduct normal meter function.

* SmartAccess Anywhere Requires Purchase



BLUETOOTH

40 ft Max distance.

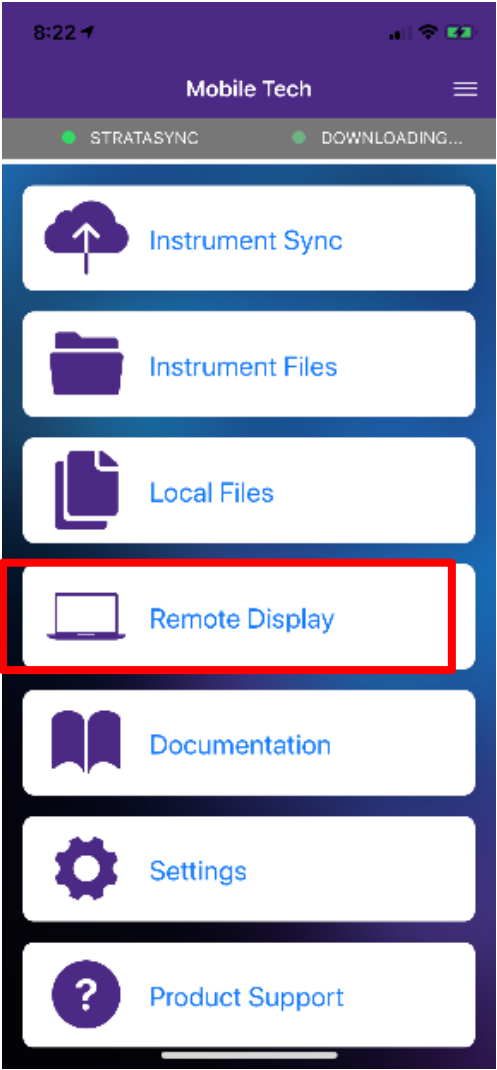
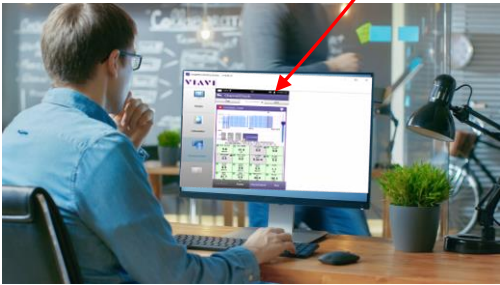
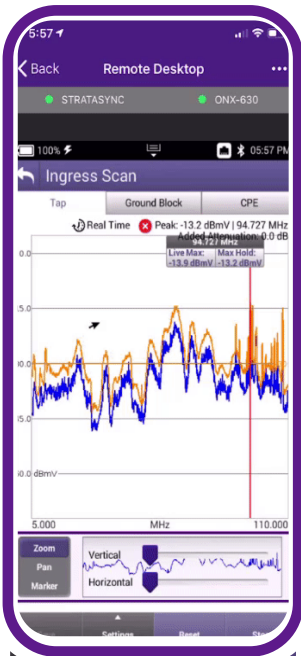

MOBILE TECH APP - LOCAL FILES

Allows users the ability to take photos or use photos from their mobile device and upload to StrataSync

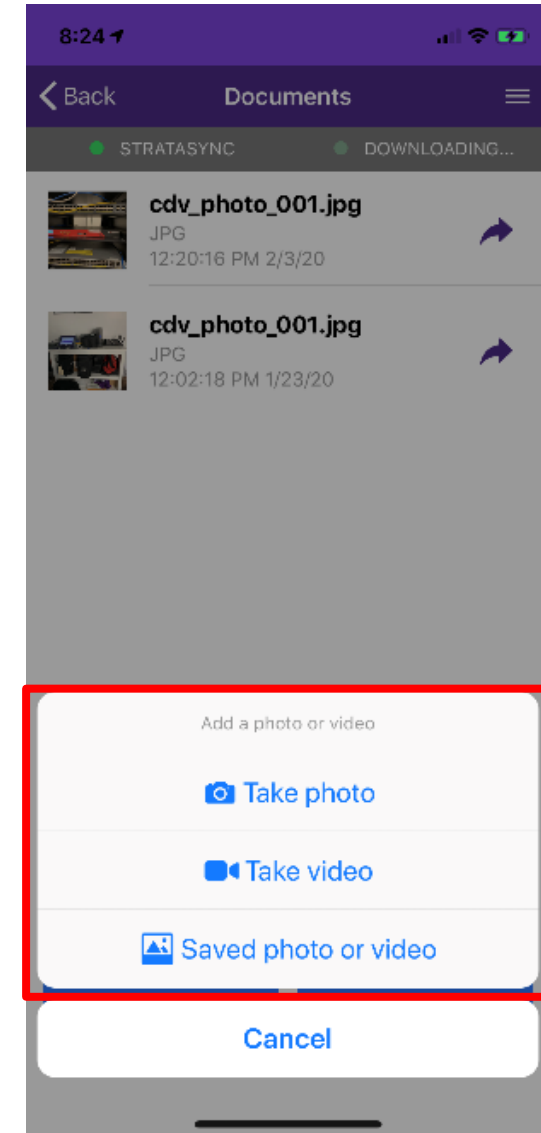
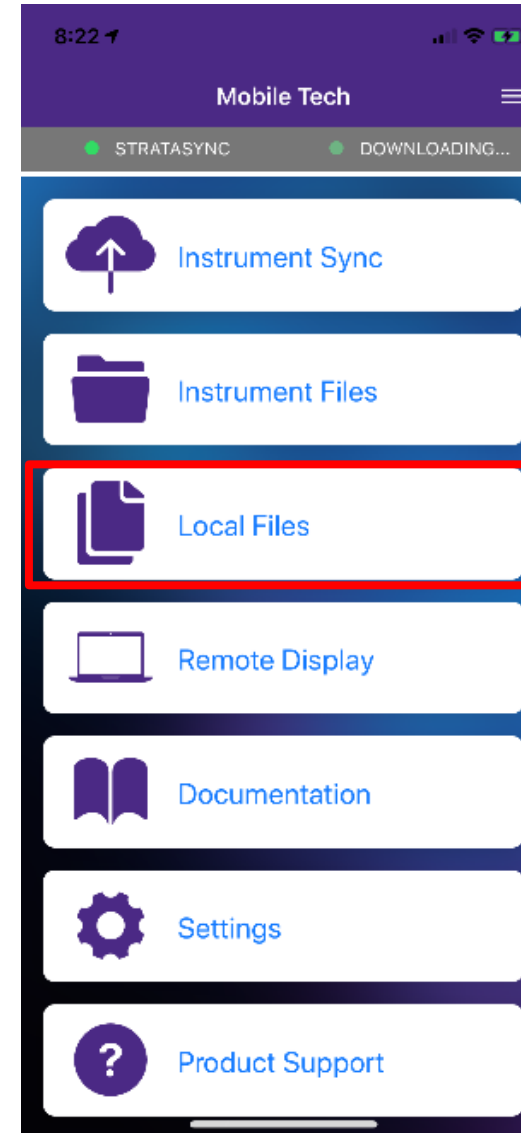

MOBILE TECH APP - Product Support and Documentation

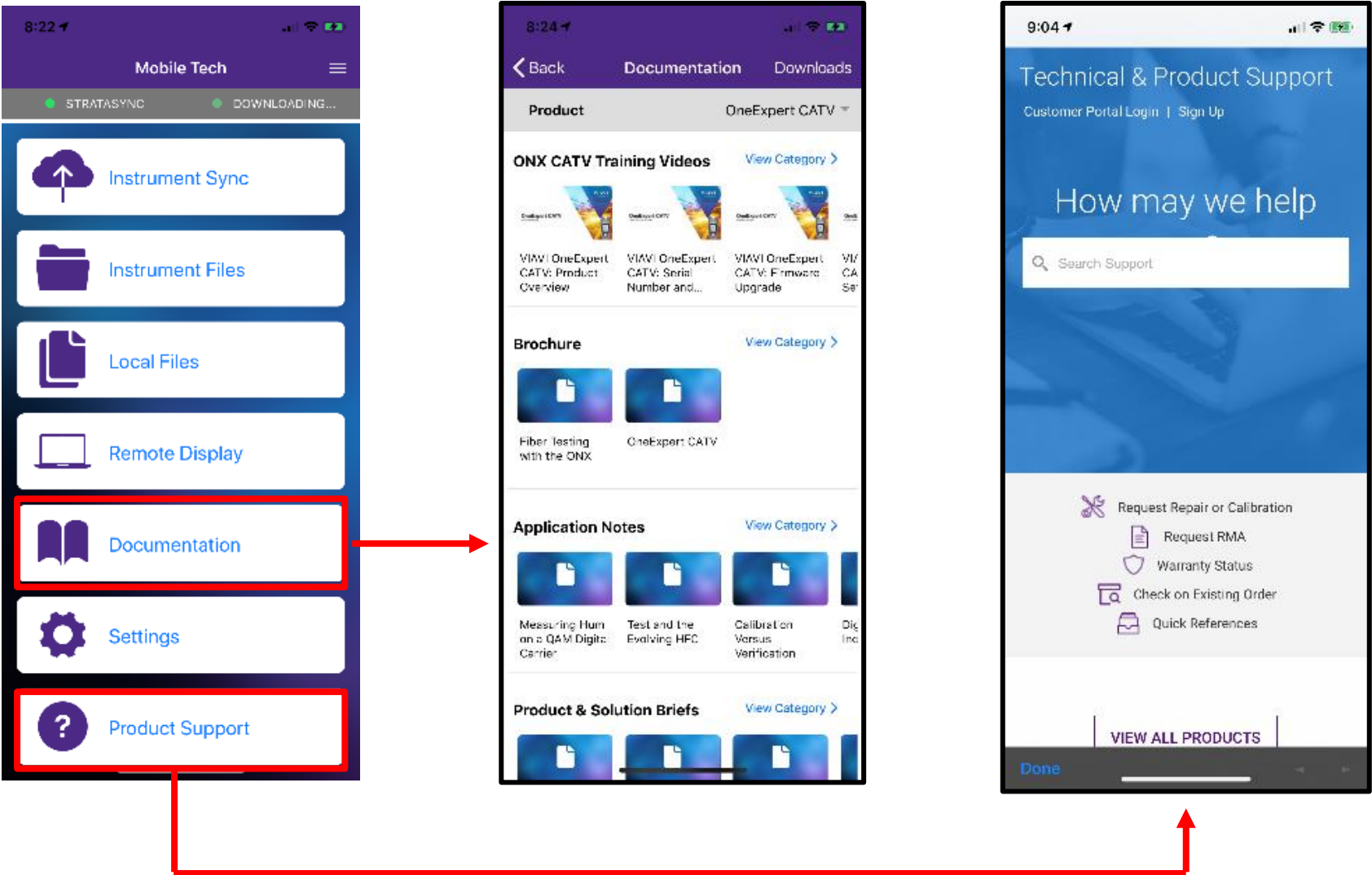

Thank You